



19 Roman Way

Kingsnorth, TN23 3ND

Guide Price £330,000

A link-detached home on the popular park farm development within easy reach of local schools, shops and countryside walks. The property comprises an entrance hall, cloakroom, sitting room, kitchen/dining room, three bedrooms, en suite and family bathroom/WC. The rear garden is pleasantly enclosed with further benefits including gas central heating, double glazing, garage and driveway. Ashford mainline station is only 2 miles away and there are some lovely countryside walks nearby.

- LINK DETACHED HOUSE
- THREE BEDROOMS
- EN SUITE & FAMILY BATHROOM/WC
- KITCHEN/DINING ROOM
- GROUND FLOOR CLOAKROOM
- GARAGE & DRIVEWAY
- EASY ACCESS TO LOCAL SCHOOLS & SHOPS
- 2 MILES FROM ASHFORD MAINLINE STATION

Viewing

Please contact our Ashford Office on 01233 646411 if you wish to arrange a viewing appointment for this property or require further information.



Floor Plan

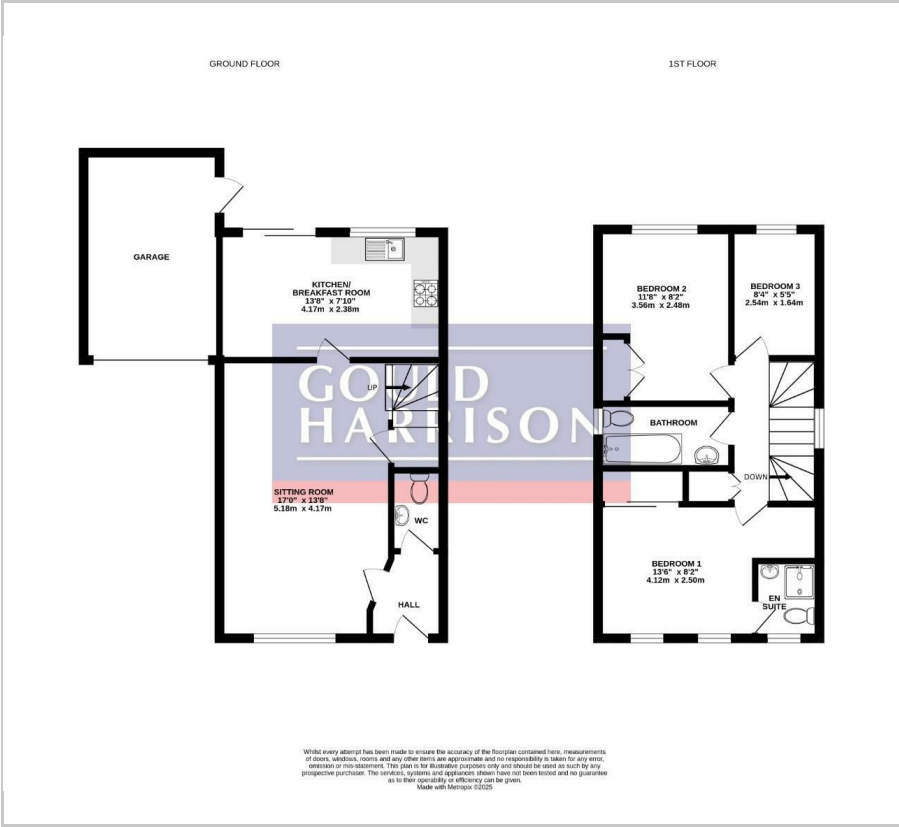

Area Map



Energy Efficiency Graph

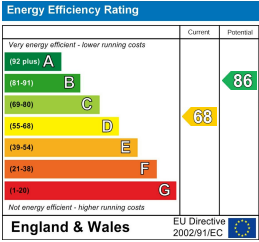

These particulars, whilst believed to be accurate are set out as a general outline only for guidance and do not constitute any part of an offer or contract. Intending purchasers should not rely on them as statements of representation of fact, but must satisfy themselves by inspection or otherwise as to their accuracy. No person in this firm's employment has the authority to make or give any representation or warranty in respect of the property.